



## *Precedent<sup>®</sup> Single-Temp*

*A complete lineup for trailers that offers more choices, greater efficiency and precise temperature control.*



TRANE  
TECHNOLOGIES™

# THE PRECEDENT LINEUP: WHERE TRADITION COMBINES WITH CUTTING EDGE TECHNOLOGY.



## THE LEADER

Since inventing refrigerated transport in 1938, Thermo King has been the world leader, designing innovative solutions for customers that utilize the latest in efficient technologies while maintaining the reliability and lowest cost of ownership the company is famous for. Add in the unmatched support and factory-trained technicians of the Thermo King dealer network and it's clear why Thermo King continues to be the driving force in transport temperature control.



### C-600

- CARB-compliant for seven years
- Delivers double digit fuel savings
- Superior temperature control
- Mechanical fuel injection
- Available shore power
- Available Eco-Pulldown
- < 25 Horsepower
- Connected straight from the factory

**Refrigeration Capacity** (System net cooling capacity at 100°F ambient and high speed engine operation)

	Engine Power w/ETV		Electric Power*	
	BTU/hr	Watts	BTU/hr	Watts
35°F	59,000	17,291	51,500	15,093
0°F	34,000	9,964	34,000	9,964
-20°F	21,000	6,154	21,000	6,154
<b>Heating Capacity</b> (System net heating capacity at 35/0°F ambient)				
BTU/hr				50,000
<b>Airflow Capacity</b>				
Volume at 0 Pa static pressure			3,350 ft <sup>3</sup> /min	

\*Thermo King offers several electric standby options. See your Thermo King dealer for specific unit performance on the option that best suits your needs.

# THE PRECEDENT S-SERIES

## THE ONLY EVERGREEN CHOICE

Developed to achieve Evergreen CARB and EPA emissions compliance\*\* while adding performance, the Precedent S-Series is notable for what it does not have: a Diesel Particulate Filter (DPF). Because of frequent stops/starts, light engine loads and low exhaust temperatures, using a DPF to achieve compliance is problematic. When considering the negative impact on engine life and fuel efficiency that a DPF brings, it was clear that a DPF was not a viable solution for units that run in California. Choose the S-Series and you'll avoid the unknowns and risks of DPFs and can rest easy knowing that you're running the only unit available that will be compliant nationwide for as long as you own it.



### S-600

- CARB Evergreen
- No need for Diesel Particulate Filter (DPF)
- Delivers double digit fuel savings
- Superior temperature control
- Electronic fuel injection with real-time fuel monitoring and recording
- Available shore power
- Available Eco-Pulldown
- >25 Horsepower
- Connected straight from the factory

**Refrigeration Capacity** (System net cooling capacity at 100°F ambient and high speed engine operation)

	Engine Power w/ETV		Electric Power*	
	BTU/hr	Watts	BTU/hr	Watts
35°F	60,000	17,584	57,000	16,705
0°F	32,000	9,378	34,000	9,964
-20°F	20,000	5,861	20,000	5,861
Heating Capacity (System net heating capacity at 35/0°F ambient)			Engine Power	
BTU/hr			59,500	
Airflow Capacity				
Volume at 0 Pa static pressure			3,350 ft <sup>3</sup> /min	



### S-700

- CARB Evergreen
- Gives you the capacity to handle deep-frozen loads
- No need for Diesel Particulate Filter (DPF)
- Delivers double digit fuel savings
- Superior temperature control
- Electronic fuel injection with real-time fuel monitoring/recording
- >25 Horsepower
- Available Eco-Pulldown
- The only deep-frozen capacity unit in the industry with available shore power operation
- Connected straight from the factory

**Refrigeration Capacity** (System net cooling capacity at 100°F ambient and high speed engine operation)

	Engine Power w/ETV		Electric Power*	
	BTU/hr	Watts	BTU/hr	Watts
35°F	68,000	19,929	50,000	14,654
0°F	37,000	10,844	35,000	10,257
-20°F	25,000	7,327	25,000	7,327
Heating Capacity (System net heating capacity at 35/0°F ambient)			Engine Power	
BTU/hr			72,000	
Airflow Capacity				
Volume at 0 Pa static pressure			3,350 ft <sup>3</sup> /min	

\*\*S-Series models, which include the S-600 and S-700, already meet Tier 4 final emissions certification by the Environmental Protection Agency (EPA) and California Air Resources Board (CARB). Further, they comply with CARB's Ultra-Low-Emission Transport Refrigeration Unit In-Use Performance Standards (ULETRU).

# THE PRECEDENT ADVANTAGE: DELIVERING PERFORMANCE AND VALUE TO YOUR BOTTOM LINE.



## TrackKing

### TELEMATICS FOR YOUR FLEET

Every Precedent trailer refrigeration unit comes connected from the factory powered by TrackKing®, making it easier for fleets to monitor and analyze their refrigerated fleet operations.

Putting this data to work gives you the ability to track and trace individual deliveries across your fleet. You'll be able to demonstrate temperature levels, meet regulatory requirements, and respond instantly to new challenges.

## DIESEL DIRECT ELECTRIC ARCHITECTURE

The Precedent platform utilizes our unique DDE (Diesel Direct Electric) architecture to drive optimum efficiencies and double-digit fuel savings across real-world applications. It's a smarter approach, with the expressed goal of making a lasting difference on your budget. When creating Precedent, we looked at diesel-electrical and diesel-mechanical designs, and after extensive analysis we chose the best of both. Precedent utilizes DDE architecture to drive optimum efficiencies and double-digit fuel savings and ensures minimal energy loss and maximized fuel efficiency and reliability when compared to other solutions.



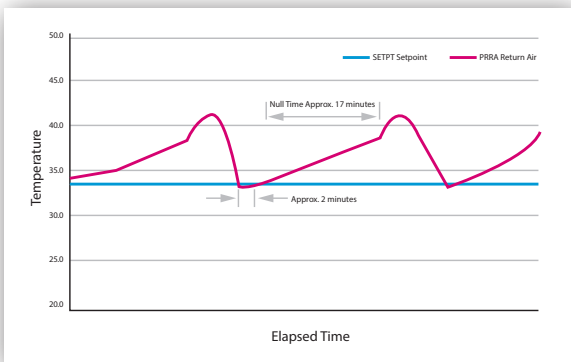

## PRECISION TEMPERATURE CONTROL

“Close enough” isn’t what your customers are looking for with their temperature-sensitive cargo. Your unit should perform as you program it to, which is just what Precedent units do. No magic, no averaging, just precise temperature control that helps ensure your loads arrive exactly as they should.

## ECO-PULLDOWN

Thermo King’s entire line of Precedent refrigeration units offer patent-pending Eco-Pulldown technology that can dramatically reduce fuel consumption. Eco-Pulldown technology takes advantage of the efficient design of the Precedent refrigeration system. This option, which can be enabled or disabled through guarded access, allows the unit to operate in low speed during initial pulldown until the temperature inside the trailer reaches setpoint. Operating the unit in Eco-Pulldown can save up to 35% in fuel usage during the initial pulldown without significantly increasing the overall unit run time. See your dealer for specific unit configuration options.

## PROVEN X-430P COMPRESSOR

The Precedent line features our X-430P compressor, which is founded on a nearly 40-year operational legacy for unmatched serviceability and substantial efficiencies. This well-proven reciprocating compressor provides the performance and reliability Thermo King is famous for and, when combined with the latest Precedent architecture, delivers better operating efficiencies than ever before.



# CUSTOMIZE WITH THE RIGHT OPTIONS FOR YOUR BUSINESS

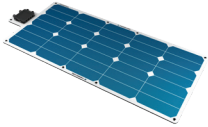

## ThermoLite® SOLAR PANELS

ThermoLite Solar Panels can deliver clean, reliable performance in a wide variety of applications, resulting in longer battery life, decreased waste, lower fuel consumption and reduced emissions.



## THERMO KING'S PERFORMANCE ADVANTAGE™ SERVICE OFFERINGS

Looking to cut costs and maximize your fleet uptime? Our range of service plans help you choose the right maintenance investment to keep you on the road and running strong. Tap in to the nation's leading experts in transport refrigeration maintenance and experience the Performance Advantage.

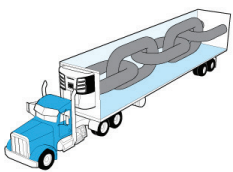

## DOOR SENSORS

Thermo King's door sensors help ensure your load is protected while reducing maintenance costs.



## STATUS LIGHTS

Featuring a "can't miss" display, Thermo King's status lights increase driver awareness of operational essentials including fuel level and load temperature to reduce the risk of load loss and other costly service issues.



## SMARTPOWER™ AND SMARTPOWER PREP

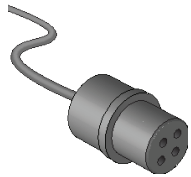

Run offshore power with three SmartPower options for Precedent. Select the voltage and capacity option that best fits your needs — then rest easy knowing all components are included in our major component warranty coverage. Choose SmartPower Prep and when the time is right, a Thermo King dealer can convert your unit from non-shore power equipped to shore power equipped in less than a day.

## SUPPLEMENTAL POWER KIT



Need a little more power to get you through the day? Look no further than our Supplemental Power Kit. It provides an additional twelve volts of power towards charging the accessory batteries — meaning more juice for your interior lighting, power lift gates, air curtains and more. Available for S-Series units only.

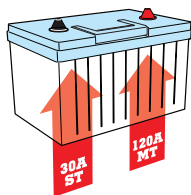

## ELECTRONIC POWER MANAGEMENT

Designed specifically for Precedent unit, the battery charger provides consistent battery charging under varying load conditions. Charging is more effective than with alternators and it comes with a 4-year parts and labor warranty. Reduce battery failures, increase fuel economy and improve uptime - this option pays for itself.



Thermo King – by Trane Technologies (NYSE: TT), a global climate innovator – is a worldwide leader in sustainable transport temperature control solutions. Thermo King has been providing transport temperature control solutions for a variety of applications, including trailers, truck bodies, buses, air, shipboard containers and railway cars since 1938. For more information, visit [thermoking.com](http://thermoking.com) or [tranetechnologies.com](http://tranetechnologies.com).

